

Hospital Cubicle Curtain & Track

Hospital Cubicle Curtain

Hospital cubicle curtain is hung around hospital beds in multiple- or single- bed wards to maintain patient privacy and therefore, is also called **privacy curtain**.

Hospital cubicle curtain fabric is required to be **flame-retardant**. LONGWAY's curtain fabric is made of flame-retardant fiber and the feature is inherent, which means it does not fade away after washing. Tests show that the fabric totally complies with **BS 5867-2:2008** Type C performance requirements. The feature remains well after 50 cycles of standard washing (in accordance with BS EN ISO 10528: Automatic machines (Type A) at 75+/-3 deg C in ECE detergent with sodium perborate, tumble dry). It can also well meet **NFPA 701** flammability requirements.

LONGWAY's Standard fabric weight is around 220g per square meter. It can also be raised up to around 270g per square meter. Usual vertical length is 2.8m, including a **50-60cm top mesh** to meet and/or exceed fire codes for fire sprinkler penetration. The mesh part also enables free air flow and light ventilation throughout the patient room.



| | |
|----------------|--|
| Material | 100% polyester |
| Width | 2.4M - 2.8M |
| Weight | 220g/square meter - 270g/square meter; |
| Mesh | 50cm, 60cm |
| Shrinkage | Lateral -0.8%; vertical-0.7% |
| Other features | Flame-retardant (after 50 cycles of washing BS5867-2:2008 Type C) |

Curtain Track and Accessories

LONGWAY curtain track is made of **well oxidized aluminum alloy**. It can be **straight, L-shaped** or **U-shaped** for enclosing patient beds, shower areas or anywhere personal privacy is required. L-shaped curtain track is usually used for multiple-bed wards and U-shaped ones for single-bed patient rooms. Tracks of **white baked enamel finish** are also available to match with white ceiling and walls.

Accessories for curtain track include end stop, pulley/glide, hook and splicing clamp. Each set of curtain track requires a pair of end stops. Usually 5 pulleys and 5 hooks are needed for each meter of track. Splicing clamp is used for U-shaped track as it is usually divided into two halves for delivery convenience; or it can also be used for connecting two straight tracks to make a longer one.

LW-TK-20 Curtain Track: 23mm*18mm*1mm

LW-TK-30 Curtain Track/ IV Pole track: 30mm*20mm*1mm



Stitching

LONGWAY also provides stitching service of cubicle curtains. There are two types of stitching. A-type is done with white cloth belt at the heading while B-type involves grommets. Pictures for both types are as follows:

A-type Stitching

B-type Stitching



Measurement

Curtain Measurement

Standard **vertical length** of fabric is 2.8m; however it can vary after stitching. Actually vertical length depends on floor-ceiling height. As suggested by Joint Commission's patient privacy standards, curtains should be **20cm-30cm above finished floor** so that it cannot come into contact with a housekeeper's mop or floor cleaner. **Horizontal width** should be at least 10% wider than track length, otherwise, the fabric's natural tendency to "relax" while hanging may

Email: enquiry@longway-tech.net

Tel/Fax: 86-512-57784916

www.longwaymed.com

www.longway-tech.net



not provide total coverage for your cubicle track. Suggested ratio between curtain and track is 1.6:1

Curtain Track Measurement

The following are suggested track size. It is also open to modification according to various onsite conditions.

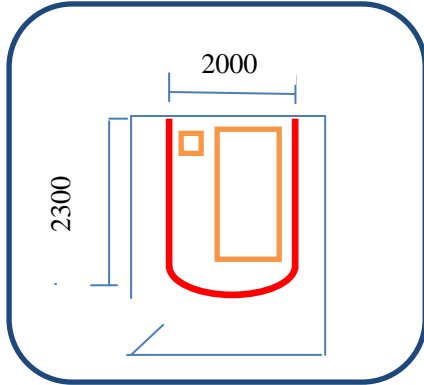

single-bed room

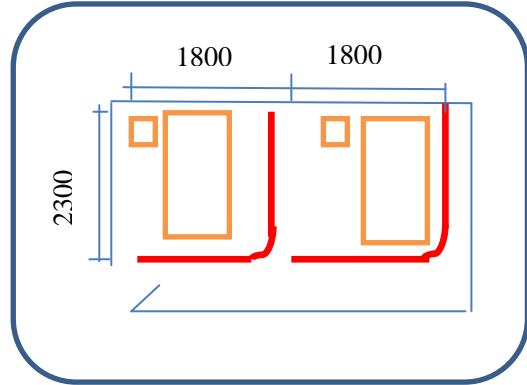

double-bed room

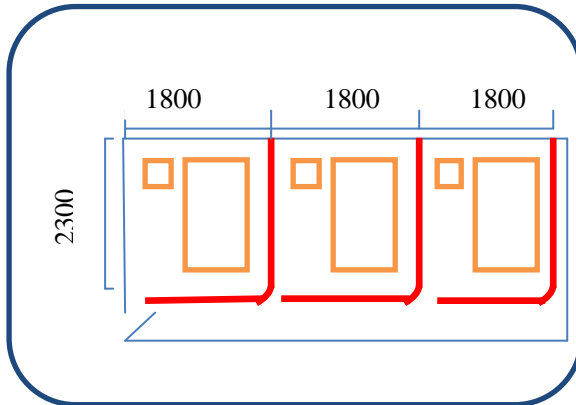

three-bed room

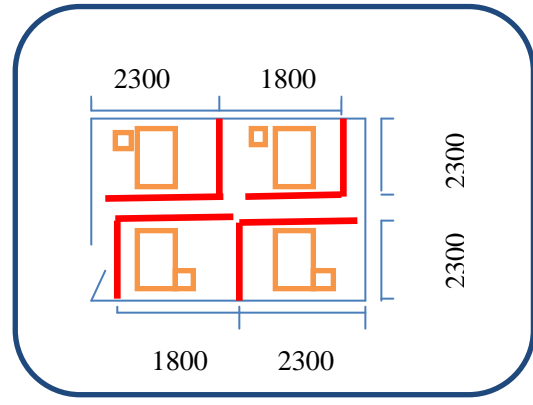

four-bed room

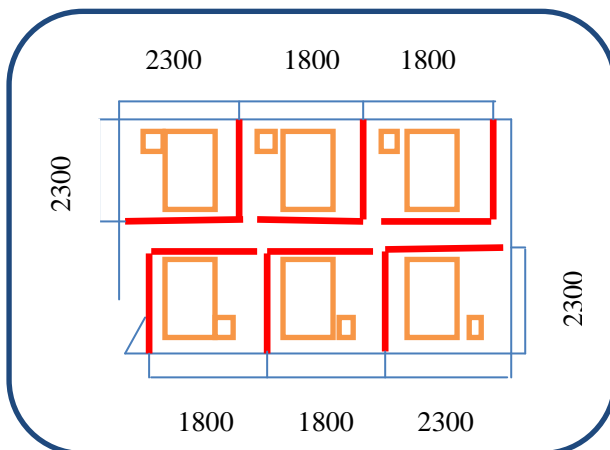

six-bed room

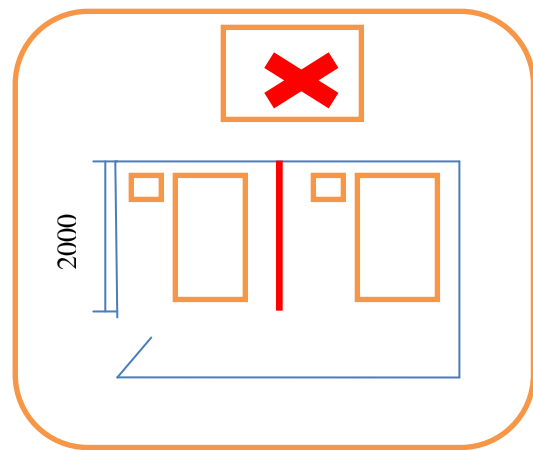

not-standard, not suggested